



- Remote 3-LED (red, yellow and green) of charge (battery fuel gauge)/error status indicator (suitable for all models of on-board chargers) and discharge (available only on models CBHD1, CBHD2 and HF1-IP) with
  - 3-LED board (code: CBNLED)
  - 3-LED compact board (code: SKLED)
  - 3-LED 18mm diameter round remote indicator (code: LBF318EZ)
  - 3-LED 22x30mm squared remote indicator (code: LBF3QEZ)
- Remote 10 segments LED Bar Graph display of charge/discharge (battery fuel gauge)/error status indicator optional (available only on models CBHD1, CBHD2 and HF1-IP) with
  - SenDec® special version of battery fuel gauge exclusively developed with S.P.E. and compatible only with S.P.E. battery chargers (code: SDxxVBDILBF where xx is the battery voltage)

- Visualizzazione remota dello stato di carica e di eventuali anomalie (in tutti i modelli di carica batterie on-board) e scarica (disponibile solo per i modelli CBHD1, CBHD2 ed HF1-IP) della batteria mediante un dispositivo a 3 LED (rosso, giallo e verde) disponibile in 3 formati differenti
  - scheda a 3 LED (codice: CBNLED)
  - scheda a 3 LED compatta (codice: SKLED)
  - indicatore rotondo a 3 LED di 18mm di diametro (codice: LBF318EZ)
  - indicatore rettangolare 22x30mm a 3 LED (codice: LBF3QEZ)
- Visualizzazione remota dello stato di carica/scarica della batteria e di eventuali anomalie mediante un dispositivo a 10 barre di LED (disponibile solo per i modelli CBHD1, CBHD2 ed HF1-IP) utilizzando
  - una versione speciale di indicatore livello batteria della SenDec® sviluppato in esclusiva con S.P.E. e compatibile solo con i carica batterie della S.P.E. (codice: SDxxVBDILBF dove xx è la tensione di batteria)

# ACCESSORIES FOR BATTERY CHARGERS / ACCESSORI PER CARICABATTERIA

SKLED

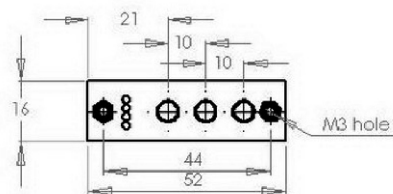
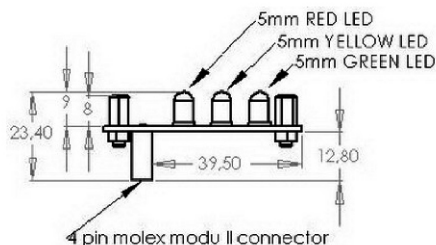

CBNLED

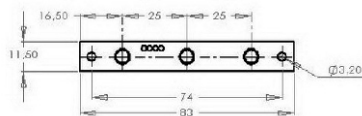
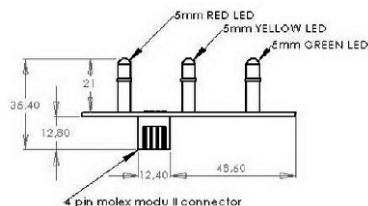

SDxxVBDILBF

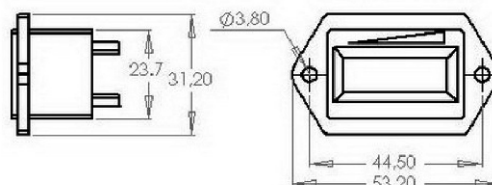
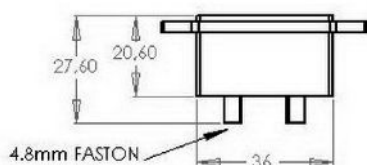

LBF318EZ

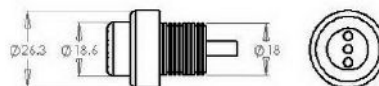
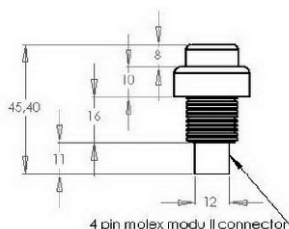

LBF3QEZ

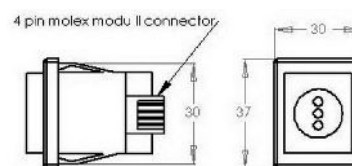
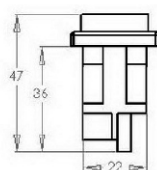

All dimensions in mm

Code: SPEDATACABLEHF (suitable for CBSW1-S, CBSW2-S, CBHF1-SM, CBHF1-V2, CBHF2 and CBHF2-XP models)

Code: SPEDATACABLEHD (suitable for CBHD1, CBHD1-XR, CBHD2 and HF1-IP models)

Cable + dedicated software to download in an Excel file the information relevant to the last 32 charging cycles (the duration of the charging cycle, the Ah's delivered by the battery, the voltage at the end of the charge and the possible error messages).

Codice: SPEDATACABLEHF (adatto ai modelli CBSW1-S, CBSW2-S, CBHF1-SM, CBHF1-V2, CBHF2 e CBHF2-XP)

Codice: SPEDATACABLEHD (adatto ai modelli CBHD1, CBHD1-XR, CBHD2 ed HF1-IP)

Cavo + software dedicato per scaricare le informazioni relative agli ultimi 32 cicli di carica (durata del ciclo di carica, Ah forniti alla batteria, tensione di fine carica ed eventuali messaggi di errore) in formato Excel.

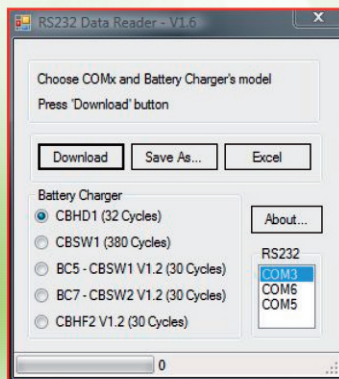

	A	B	C	D	E	F	G	H
1	RS232 Data Reader - V1.6							
2	Battery Charger = CBHD1 (32 Cycles)							
3								
4	Last =	23						
5								
6	Error	#Curve	Voltage	Current	TotAh	TotTime	#Yellow	#
7	NO_ERR	IUuo-Gel	12V	6A	nc	3,1	1	1
8	NO_ERR	IUuo-Gel	12V	6A	nc	5,2	1	2
9	NO_ERR	IUuo-Gel	12V	6A	nc	4,5	0	3
10	NO_ERR	IUuo-Gel	12V	6A	nc	3,3	1	4
11	NO_ERR	IUuo-Gel	12V	6A	nc	4,3	0	5
12	NO_ERR	IUuo-Gel	12V	6A	nc	4,1	0	6
13	ERR_E04	IUuo-Gel	12V	6A	nc	2,2	0	7
14	ERR_E04	IUuo-Gel	12V	6A	nc	0,2	0	8
15	ERR_E04	IUuo-Gel	12V	6A	nc	3,9	0	9
16	NO_ERR	IUuo-Gel	12V	6A	nc	2,6	0	10
17	ERR_E04	IUuo-Gel	12V	6A	nc	3,2	0	11
18	NO_ERR	IUuo-Gel	12V	6A	nc	4,4	0	12
19	NO_ERR	IUuo-Gel	12V	6A	nc	5,4	1	13
20	NO_ERR	IUuo-Gel	12V	6A	nc	7,8	1	14
21	ERR_E04	IUuo-Gel	12V	6A	nc	0,7	0	15
22	ERR_E04	IUuo-Gel	12V	6A	nc	1,4	0	16
23	ERR_E04	IUuo-Gel	12V	6A	nc	0,9	0	17
24	ERR_E04	IUuo-Gel	12V	6A	nc	8,6	0	18
25	ERR_E04	IUuo-Gel	12V	6A	nc	0,2	0,2	19
26	NO_ERR	IUuo-Gel	12V	6A	nc	2,1	1	20
27	NO_ERR	IUuo-Gel	12V	6A	nc	3,4	1	21
28	NO_ERR	IUuo-Gel	12V	6A	nc	1	1	22
29	NO_ERR	IUuo-Gel	12V	6A	nc	0,2	0	23
30	NO_ERR	IUua-OPT	12V	6A	nc	25,5	25,5	24
31	NO_ERR	IUua-OPT	12V	6A	nc	25,5	25,5	25
32	NO_ERR	IUua-OPT	12V	6A	nc	25,5	25,5	26
33	NO_ERR	IUua-OPT	12V	6A	nc	25,5	25,5	27
34	NO_ERR	IUua-OPT	12V	6A	nc	25,5	25,5	28
35	NO_ERR	IUua-OPT	12V	6A	nc	25,5	25,5	29
36	NO_ERR	IUua-OPT	12V	6A	nc	25,5	25,5	30
37	NO_ERR	IUua-OPT	12V	6A	nc	25,5	25,5	31
38	NO_ERR	IUua-OPT	12V	6A	nc	25,5	25,5	32